

February 20, 2025

ADDENDUM NO. 2



RE: Building and Site Demolition
Bridge Valley Community and Technical College
619 Second Avenue
Montgomery, West Virginia 25136
Architect's Project No. 24079

TO: Prospective Bidders

FROM: ZMM, Inc. Architects and Engineers

This Addendum forms a part of the Contract Documents and modifies the original Bidding Documents.

ATTACH THIS ADDENDUM TO THE FRONT COVER OF THE PROJECT MANUAL AND ACKNOWLEDGE RECEIPT OF THIS ADDENDUM IN THE SPACE PROVIDED ON THE BID FORM.

PART 1 - INFORMATION FOR BIDDERS

- A. The attached Pinnacle/CSI Roof Sampling Report indicates no ACM in the roofs of the Engineering Lab Building and Engineering Classroom Building.

PART 2 - CHANGES TO DRAWINGS

- 1. REPLACE Sheet C101R1 Site Demolition Plan (issued in Addendum No. 1) with Sheet C101R2 as attached to this Addendum.
 - a. Clarification: Refer to the two existing buildings to be demolished and note that the building to the west is the 6-story building and the building to the east is the 2-story building.

END OF ADDENDUM

Attachments: Pinnacle/CSI Roof Sampling Report2 pages
Sheet C101R2 42" x 30"

Blacksburg
1116 South Main Street
Blacksburg, Virginia 24060
(540) 552-2151

Charleston
222 Lee Street West
Charleston, West Virginia 25302
(304) 342-0159

Marietta
149 Acme Street, Suite A
Marietta, Ohio 45750
(740) 371-9001

Martinsburg
5550 Winchester Avenue
Berkeley Business Park, Suite 5
Martinsburg, West Virginia 25405
(304) 342-0159



10 INDEPENDENT AVENUE
 NITRO, WV 25143
 PHONE 304.757.5204
 FAX 304.440.3465
 www.pinnaclecorp.net

ASBESTOS IDENTIFICATION BY POLARIZED LIGHT MICROSCOPY ANALYSIS

Attn: Michael McCallister
 Custom Services Industries LLC
 533 R 3rd Avenue
 Huntington, WV 25704

Client Project/PO#: 24147
 PC Project #:
 Received Date: 9/20/2024
 Analysis Date: 9/20/2024

RE: BridgeValley Community & Technical College - Montgomery, WV

CLIENT ID #:	LAB ID #:	LOCATION:	COLOR:
MMCSI-01	24B-20285	North side of Engineering Lab bldg.	Black
Texture/Description: Solid/Roofing			
TOTAL ASBESTOS: 0 %			
Cellulose: 0 % Fiber Glass: 33% Others: 0% Filler/Binder: 67 %			

CLIENT ID #:	LAB ID #:	LOCATION:	COLOR:
MMCSI-02	24B-20286	South side of Engineering Lab bldg.	Black
Texture/Description: Solid/Roofing			
TOTAL ASBESTOS: 0 %			
Cellulose: 0 % Fiber Glass: 25% Others: 0% Filler/Binder: 75 %			

CLIENT ID #:	LAB ID #:	LOCATION:	COLOR:
MMCSI-03	24B-20287	Engineering Classroom bldg., N Side of Penthouse	White
Texture/Description: Solid/Cementitious Siding			
TOTAL ASBESTOS: 0 %			
Cellulose: 0 % Fiber Glass: 0% Others: 0% Filler/Binder: 100%			

CLIENT ID #:	LAB ID #:	LOCATION:	COLOR:
MMCSI-04	24B-20288	Engineering Classroom bldg., S Side of Penthouse	White
Texture/Description: Solid/Cementitious Siding			
TOTAL ASBESTOS: 0 %			
Cellulose: 0 % Fiber Glass: 35% Others: 0% Filler/Binder: 65 %			

CLIENT ID #:	LAB ID #:	LOCATION:	COLOR:
MMCSI-05	24B-20289	Engineering Classroom bldg.	Black
Texture/Description: Solid/Core Roofing			
TOTAL ASBESTOS: 0 %			
Cellulose: 0 % Fiber Glass: 45% Others: 0% Filler/Binder: 55 %			

Analytical Method: Polarized light microscopy using dispersion staining (App. E to Sub. E of 40 CFR Part 763 and EPA/600/R-93/116). PLM should not be used to demonstrate the absence of asbestos in floor tiles. All samples will be held for thirty (30) days unless otherwise requested. This report relates only to items tested and makes no statement as to the contents of surrounding materials and apply to the sample as received. Multi-layered material which have distinct and separable layers shall be reported separately. This report shall not be reproduced, except in full, without written permission. The results of this report should not be used by the client to claim product certification, approval, or endorsement by NVLAP, NIST, or any agency of the U.S. Government.

Analyzed by: _____
 Casey Brown



Custom Services Industries
 533 R 3rd Avenue
 Huntington, WV 25701
 (681) 204-5366

Asbestos - Chain of Custody
 Job Number: 24147
 Date Collected: 09/16/2024
 Collected By: Mike McCallister

Turn Around Time Requested
 Rush (1-2 Hours)
 Same Day (4 Hours)
 Next Day (24 Hours)
 48 hours (2 Days)

Standard (3-5 Days)

Contact Name: Mike McCallister
Job Name: BridgeValley Community & Technical College

City/State: Montgomery, WV

TYPE OF ANALYSIS REQUESTED

ASBESTOS

PCM (AIR SAMPLES) PLM (Bulk Samples)
 TEM Analysis Point Count (If Applicable)
 Analyze to Positive

FUNGAL SPORE

Spore Trap (Air)
 Direct Exam (Tape)

LEAD

XRF Soil
 Wipe Chips

Sample #	Sample Name	Time On	Time Off	Avg. Rate	Volume	Analysis Type	Turn Around	Pos. Stop
MMCSI-01	Roofing_North side of Engineering Lab bldg.	248						
MMCSI-02	Roofing_South side of Engineering Lab bldg.	20285						
MMCSI-03	Cementitious Siding_Engineering Classroom bldg., North Side of Penthouse	20286						
MMCSI-04	Cementitious Siding_Engineering Classroom bldg., South Side of Penthouse	20287						
MMCSI-05	Core Roofing Sample_Engineering Classroom bldg.	20288						
		20289						

Relinquished By: Sharon Swann Date: 9/19/24
 Received By: Casey Swann Date: 9/20/24

EXISTING LEGEND

	PROPERTY CORNER
	PROPERTY LINE
	ADJACENT PROPERTY LINE
	INDEX CONTOUR
	INTERMEDIATE CONTOUR
	TREE LINE
	OVERHEAD ELECTRIC
	WATER
	SANITARY SEWER
	STORM SEWER
	GAS
	SANITARY MANHOLE
	UTILITY POLE
	FIRE HYDRANT
	LIGHT POLE
	WATER VALVE

GENERAL NOTES

- SITE SURVEY PERFORMED BY: TERRADON CORPORATION, 409 JACOBSON DRIVE, POCA, WV 25159, PHONE: (304) 755-8291
- CONSULT AN ATTORNEY FOR TITLE OF JEFFERSON STREET AND 8' ALLEY THROUGH SUBJECT TRACT.
- FLOODPLAIN INFORMATION: THIS PARCEL IS LOCATED IN ZONE X AS SHOWN ON FLOOD INSURANCE RATE MAP NUMBER 54019C037D EFFECTIVE DATE SEPTEMBER 03, 2010.
- VERTICAL DATUM REFERENCED NAVD 88, AND WAS OBTAINED BY ON SITE GPS OBSERVATION AT THE TIME OF THIS SURVEY.
- HORIZONTAL DATUM REFERENCED TO WV STATE PLANE COORDINATE SYSTEM OF 1983, WV SOUTH ZONE AND WAS OBTAINED BY ON SITE GPS AT THE TIME OF THIS SURVEY.
- UNDERGROUND UTILITIES SHOWN HEREON WERE TAKEN FROM MARKINGS RESULTING FROM A MISS UTILITY LOCATE REQUEST. ALL UNDERGROUND UTILITIES MAY NOT BE SHOWN.
- SEE MAP I.J. SETTLE'S MAP OF COAL VALLEY CITY NOW MONTGOMERY, W. VA. NOVEMBER 12, 1919 RECORDED IN THE CLERK OF KANAWHA COUNTY IN MAP BOOK 7 PAGE 12.
- SEE WVDOT PLANS ROUTE W.VA. 61 PROJECT NO. F-283 (16) CONT. 2, FAYETTE AND KANAWHA 1967, MONTGOMERY-MORRIS CREEK RELOCATION.
- SEE BOUNDARY PLATS RECORDED IN DB. 1560 PG. 304-A, DB. 559 PG. 356-A, DB. 1610 PG. 22.
- SEE MAP SHOWING GENERAL SEWER MAP CITY OF MONTGOMERY RECORDED IN MAP BOOK 21 PAGE 23.
- RELOCATION / ABANDONMENT, AND/OR DAMAGES TO EXISTING UTILITIES ENCOUNTERED DURING CONSTRUCTION IS THE RESPONSIBILITY OF THE CONTRACTOR AND ALL ASSOCIATED COSTS SHALL BE PAID FOR BY THE CONTRACTOR.
- CONTRACTOR SHALL COORDINATE ANY REMOVAL / RELOCATION OF WATER, SEWER, GAS, OR OTHER SERVICE WITH LOCAL UTILITY COMPANIES PRIOR TO START OF CONSTRUCTION.

UTILITY CONTACTS

POWER AMERICAN ELECTRIC POWER CO. (304) 348-4172	WATER WEST VIRGINIA AMERICAN WATER (WVAV) RANDY BLANKENSHIP (304) 932-6627
STORM AND SANITARY SEWER CITY OF MONTGOMERY C/O DWAYNE ISAACS (304) 640-0788	GAS HOPE GAS 1-800-688-4673

* CONTACT CITY OF MONTGOMERY TO INSPECT CAPPED STORM AND SANITARY LINES BEFORE BACKFILLING.

DEMOLITION NOTES

- CALL MISS UTILITY OF WEST VIRGINIA TWO WORKING DAYS BEFORE DIGGING 1-800-245-4848.
- CONTRACTOR SHALL REVIEW SITE AREA AND INCLUDE REMOVAL OF TRASH / DEBRIS ON SITE.
- EROSION AND SEDIMENT CONTROLS SHALL BE INSTALLED PRIOR TO DEMOLITION ACTIVITIES. SEE EROSION AND SEDIMENT CONTROL NOTES.
- ITEMS IN BOLD TO BE REMOVED IN ENTIRETY.
- CONTRACTOR IS RESPONSIBLE FOR LOCATION AND COORDINATION WITH ALL BELOW AND ABOVE GROUND UTILITIES.
- EXISTING ABOVE GROUND AND UNDERGROUND UTILITIES TO REMAIN SHALL BE PROTECTED AT ALL TIMES, UNLESS OTHERWISE NOTED.
- BACKFILL FOR VOIDS LEFT BY DEMOLITION ACTIVITIES SHALL BE PLACED AND COMPACTED IN STRICT ACCORDANCE WITH SPECIFICATIONS. BACKFILL SHALL BE FLUSH WITH ADJACENT GRADES AND DRAIN TO EXISTING INLETS OR ROAD.
- TREES AND VEGETATION, INCLUDING ROOT BALLS, WITHIN PROJECT LIMITS SHALL BE REMOVED.
- TOPSOIL SHALL BE STRIPPED AND STOCKPILED PRIOR TO EXCAVATION AND FILL PLACEMENT.
- THE LOCATION OF EXISTING SUBSURFACE UTILITIES AS SHOWN ON THESE PLANS ARE NOT TO BE RELIED ON AS EXACT OR COMPLETE. CONTRACTOR IS RESPONSIBLE TO VERIFY THE LOCATION OF ALL EXISTING UTILITIES. ANY CONFLICTS WITH INFORMATION SHOWN ON THESE PLANS SHALL BE BROUGHT TO THE ATTENTION OF THE OWNER AND ARCHITECT IMMEDIATELY.
- FIELD VERIFY GRADES, EXISTING ABOVE AND BELOW GROUND UTILITIES, DIMENSIONS, AND ELEVATIONS BEFORE EXECUTING WORK. REPORT ANY VARIATIONS TO ARCHITECT.
- LAWN AREAS DISTURBED DURING CONSTRUCTION SHALL BE REGRADED, SEEDED, AND MULCHED TO ORIGINAL CONDITIONS, UNLESS OTHERWISE NOTED.
- PROTECT EXISTING SITE IMPROVEMENTS TO REMAIN. ADJACENT BUILDINGS, SIDEWALKS, PAVED AREAS, AND OTHER SITE FEATURES SOILED OR DAMAGED DURING CONSTRUCTION SHALL BE CLEANED OR REPAIRED TO ORIGINAL CONDITION, UNLESS OTHERWISE NOTED.
- PROVIDE 6" CHAINLINK TEMPORARY FENCING ALONG LIMITS OF WORK TO SECURE CONSTRUCTION AREA. COORDINATE LOCATION WITH OWNER.
- REMOVE INLETS THAT DISCHARGE TO BUILDING PIPING SYSTEMS. KEEP AND PROTECT EXISTING INLETS AND PIPING THAT DISCHARGE TO THE RIGHT-OF-WAY.
- MASONRY AND BRICK RESULTING FROM BUILDING AND WALL DEMOLITION MAY BE USED AS BACKFILL. DISCUSS USE OF DEMOLITION DEBRIS WITH GEOTECHNICAL ENGINEER OF RECORD BEFORE PROCEEDING. MASONRY AND BRICK SHALL BE CRUSHED AND MEET THE SPECIFICATIONS FOR SATISFACTORY SOILS AND COMPACTION (SPECIFICATION SECTION 312200). GEOTEXTILE SEPARATION FABRIC SHALL BE PLACED OVER CRUSHED MASONRY AND BRICK BEFORE INSTALLING BACKFILL ABOVE.

DEMOLITION LEGEND

	REMOVE CONCRETE
	REMOVE ASPHALT
	REMOVE BUILDING (INCLUDING SLABS AND STEM WALLS BUT NOT FOOTINGS)

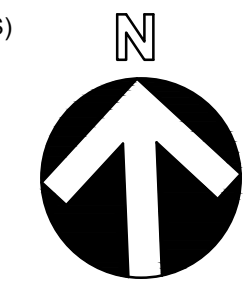

SCALE: 1" = 20'
FEET

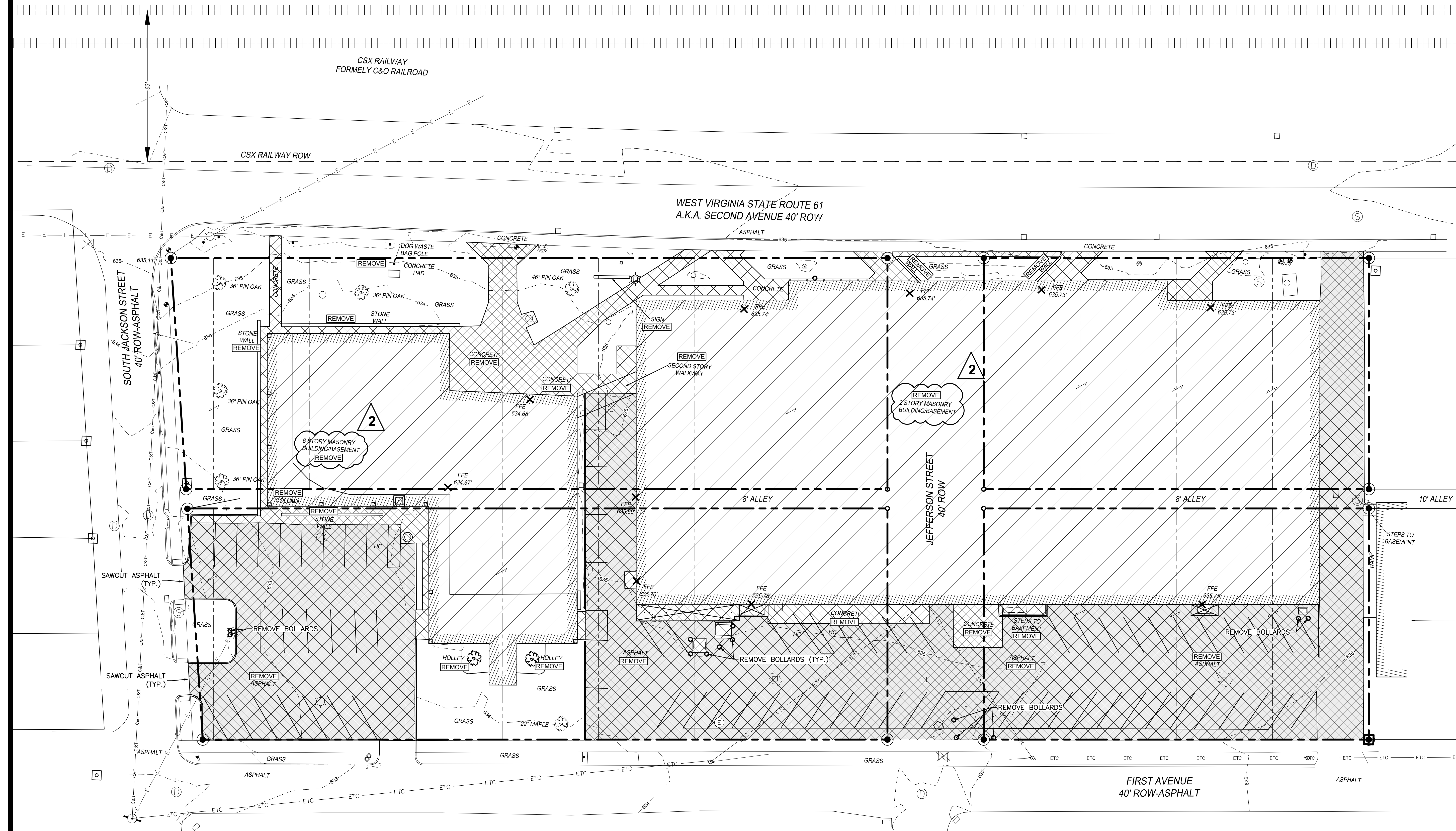

NO.	REVISIONS	DATE
1	ADDITIONAL NO. 1	02-14-25
2	ADDITIONAL NO. 2	02-20-25

BUILDING AND SITE DEMOLITION FOR
BRIDGEVALLEY COMMUNITY AND TECHNICAL COLLEGE
800 SECOND AVE
MONTGOMERY, WEST VIRGINIA
CONSTRUCTION DOCUMENTS

© by ZMM, INC.

SITE DEMOLITION PLAN

DRAWN ACD	CHECKED BSM
DATE 01 . 28 . 2025	
COMM. NO. 24079	

C101R2