



To: ALL BIDDERS
Ref: NEW RIVER C & TC – GREENBRIER HALL ROOF RENOVATION
Subj.: ADDENDUM BULLETIN NO. 4

This Addendum Bulletin shall be incorporated in the Construction Documents including the Drawings and Specifications for the Project referenced above. All work amended as listed herein shall be included in your Bid Proposal and the bidder shall acknowledge this addendum bulletin on the Bid Form.

The work shall be amended as follows:

SPECIFICATIONS

1. **00300 Form of Proposal:** REPLACE section in its entirety, see Enclosures.

DRAWINGS:

1. A-5.2: REPLACE sheet in its entirety, see Enclosures. Updated have been clouded and tagged. Revisions relate to roof details.

FOR CLARIFICATION:

- a. Porch roofs to receive FlashCo's TPO FlashDrain Drain Boots as Basis of Design, comparable products may be used upon approval by Architect.
- b. Cornice gutter to receive Hercules RetroDrain TPO Coated Flange 4" as Basis of Design at all downspout locations, comparable products may be used upon approval by Architect.

END OF ADDENDUM

Submitted by:
THE OMNI ASSOCIATES – ARCHITECTS, INC.

Enclosures:

- A Bid Phase RFI Log
- B Form of Proposal
- C Sheet A-5.2

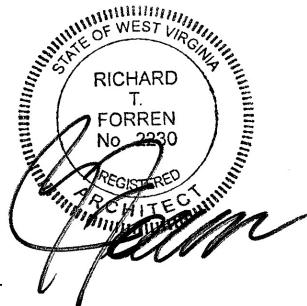

Richard T. Forren, AIA, Principal

Bid Phase PBI Report

	Question	Response	In Addendum
1	Are there any controls required to mitigate welding fumes/smoke from interior framing work? Is there an ability to put smoke alarms into test mode on the days where there is welding going on inside the building?	Smoke alarms can be put into test mode for welding fumes/smoke. When smoke alarms are in test mode, contractor to provide whole building fire watch.	4
2	Are there any restrictions on work hours for internal steel framing work?	Normal maintenance hours are 8-4. If work needs to occur outside of these hours, coordination needs to occur with the college and appropriate faculty.	4
3	Would the owner be willing to make contract changes outlines in attachment A to this document?	Contract changes will not be made during bidding phase. Once project is awarded questions can be addressed.	4
4	Please clarify what gauge you are requesting the continuous cleat on the coping metal to be. The coping thickness is stated at 22-gauge	20-gauge.	4
5	Please verify that the attachment method for the insulation is adhered. The specifications do not list an attachment method.	Insulation to be adhered per manufacturers standard.	4
6	Based on the information found during the core cuts at the onsite visits, will a fully tapered ¼" insulation system still be required?	Yes.	4
7	The standard contractor warranty length associated with a 20-year manufacturer warranty is 2 years. Would a 2-year contractor warranty be acceptable with the 20-year NDL manufacturer warranty?	Contractor warranty to be 5 years.	4
8	Drawing A-1.2 calls for a vapor retarder sheet over the concrete decking for the single ply membrane roof areas. However, the specifications do not list out acceptable vapor retarders. Please provide a specification for acceptable vapor retarders.	Manufacturer(s) adhering to criteria listed in 075423 Thermoplastic-Polyolefin (TPO) Roofing Section 2.5 Vapor Retarder acceptable for use.	4
9	Drawing A-1.2 calls for ½" OSB sheathing over the concrete decking on the shingled section of the building. However, in the specifications I cannot find where that is called for. Please clarify if ½" OSB sheathing is required over the concrete decking in this area.	Yes, 1/2" OSB sheathing is required over existing concrete roof assembly. Intent is to replace existing sheathing and wood sleepers (if present) with new.	4
10	In lieu of a ¼" gypsum coverboard, would a ½" HD coverboard be acceptable?	Provide coverboard specified in drawings and specifications.	4
11	Can you please identify areas and quantities of soffit that are to be removed and replaced?	Replacement of soffit to occur on East & West side roofs. Areas to be verified by bidders prior to bid submission.	4
12	Can you please identify areas and quantities of downspouts that are to be removed and replaced?	Downspouts on East & West porch roofs to be replaced in entirety.	4
13	Is there any asbestos present in any areas that are specified for demolition? Has the existing BUR on the lower roofs been tested for asbestos containing materials?	It is not expected that hazardous materials, such as asbestos-containing materials, will be encountered in the Work. No asbestos testing has been performed to date.	4
14	Based upon conversations with various manufacturer representatives the water-table would be viewed as a drainage/gutter system. This is typically a non-warrantable area of a roofing system. Per their understanding, the roofing system warranty would end at the exterior side of the scupper. Please verify this would be acceptable.	Warranty must cover all areas where membrane roofing is installed.	4

SECTION 00300 – FORM OF PROPOSAL

BID TO THE OWNER: West Virginia Community and Technical College System
2001 Union Carbide Drive, Building 2000
South Charleston, WV 25303

PROJECT: **RFB 26241**
New River Community and Technical College
Roof Renovation

Bidder's Name: _____

The undersigned, hereinafter called "Bidder," being familiar with and understanding the Bidding Documents, and also having examined the site and being familiar with all local conditions affecting the Project, hereby proposes to furnish all labor, material, equipment, supplies and transportation, and to perform all Work in accordance with the Bidding and Contract Documents within the time set forth below for the sum of:

BASE BID: \$ _____

(Amount to be shown in both words and numbers. In the event of a difference between the written amount and the number amount, the written amount shall prevail.)

The Bidder, if successful and awarded a Contract, agrees that all Work is to be Substantially Complete within one hundred and twenty (120) consecutive calendar days following receipt of Owner's written Notice to Proceed and agrees to achieve Final Completion within 30 consecutive calendar days thereafter.

ALLOWANCES: Refer to spec section, amounts are included in the base bid.

A. Roof sheathing:
\$

(Amount to be shown in both words and numbers. In the event of a difference between the written amount and the number amount, the written amount shall prevail.)

B. Equipment Curbs
\$

(Amount to be shown in both words and numbers. In the event of a difference between the written amount and the number amount, the written amount shall prevail.)

C. Parapet Wall Sheathing
\$

(Amount to be shown in both words and numbers. In the event of a difference between the written amount and the number amount, the written amount shall prevail.)

NEW RIVER C & TC – ROOF RENOVATION

RESPECTFULLY SUBMITTED:

SIGNATURE: _____ DATE: _____
Signature in Ink

NAME: _____ *Corporate Seal if Applicable*
Please Type or Print

TITLE: _____

BIDDERS NAME: _____
BIDDERS
ADDRESS: _____

TELEPHONE: _____

EMAIL: _____

CONTRACTOR'S
LICENSE NO.: _____

CONTRACTOR'S LICENSE

West Virginia Code §30-42 requires that all persons desiring to perform contractual work in West Virginia must be duly licensed. The West Virginia Contractor Licensing Board is empowered to issue a contractor's license. Application for a contractor's license may be made by contacting the West Virginia Contractor Licensing Board, Building 3, Room 200, 1900 Kanawha Boulevard, East, Charleston, West Virginia 25305. Telephone: (304) 558-7890. West Virginia Code §30-42 requires any prospective Bidder to include the contractor's license number on or with its Bid. Successful Bidder will be required to furnish a copy of their contractor's license prior to issuance of a Purchase Order/Contract.

**AFFIDAVITS (on the following pages) – TO BE SUBMITTED WITH BID OR AS OTHERWISE
PERSCRIBED BY LAW**

- PURCHASING AFFIDAVIT: West Virginia code §5A-3-10A states that no contract or renewal of any contract may be awarded by the state or any of its political subdivisions to any vendor or prospective vendor when the vendor or prospective vendor or a related party to the vendor or prospective vendor is a debtor and the debt owed is an amount greater than \$1,000 in the aggregate. The Bidder (vendor) shall execute and submit with its bid, or as otherwise prescribed by West Virginia Code, the Purchasing Affidavit provided in the Bidding Documents.
- DRUG-FREE WORKPLACE CONFORMANCE AFFIDAVIT: West Virginia Code §21-1D-5 requires each contractor that submits a bid for the work to submit an affidavit that the contractor has a written plan for a drug-free workplace policy prior to being awarded a contract. The contractor (bidder/vendor) shall execute and submit with its bid, or as otherwise prescribed by West Virginia Code, the Drug-Free Workplace Conformance Affidavit provided in the Bidding Documents.

CERTIFIED DRUG-FREE WORKPLACE REPORT

NEW RIVER C & TC – ROOF RENOVATION

In accordance with West Virginia Code §21-1D-7b, no less than once per year, or upon completion of the project, every contractor shall provide a certified report to the public authority which let the contract. That report must include each of the items identified in the Required Report Content section of the Certified Drug-Free Workplace Report Coversheet.

DISCLOSURE OF INTERESTED PARTIES TO CONTRACTS

Pursuant to West Virginia Code §6D-1-2, a state agency may not enter into a contract, or a series of related contracts, that has/have an actual or estimated value of \$1 million or more until the business entity submits to the contracting state agency a Disclosure of Interested Parties to the applicable contract. In addition, the business entity awarded a contract is obligated to submit a supplemental Disclosure of Interested Parties reflecting any new or differing interested parties to the contract within 30 days following the completion or termination of the applicable contract.

The Disclosure Form is available at the following URL: <http://www.ethics.wv.gov/Pages/forms.aspx>

VENDOR REGISTRATION AND DISCLOSURE STATEMENT

The successful Bidder must be a registered vendor with the West Virginia Department of Administration, Purchasing Division, prior to receiving a contract/purchase order. Vendor registration information is available at the following URL: <http://www.state.wv.us/admin/purchase/vrc/wv1.pdf>

LIQUIDATED DAMAGES

The Owner will suffer financial loss if the Work is not Substantially Complete within the Contract Time following the date established for commencement of the Work in the notice to proceed and/or purchase order. As liquidated damages, and not as a penalty, the Contractor and the Contractor's surety shall be liable for and shall pay the Owner the sum of \$ One Thousand Dollars (\$1000) per day until Substantial Completion is achieved.

Allowances may be made for delays due to shortages of materials and/or energy resources, subject to proof by documentation, and for delays due to strikes or other delays beyond the control of the Contractor. All delays and any claim for extension of Contract Time must be properly documented in accordance with the General Conditions of the Contract for Construction, AIA Document A201-2017, and the State of West Virginia Supplementary Conditions to AIA Document A201-2017.

ADDENDA ACKNOWLEDGMENT

The undersigned hereby acknowledges receipt of the following Addenda and has taken the information contained therein into full consideration in the formulation of this Bid.

Addenda No. 1 _____
 No. 2 _____
 No. 3 _____
 No. 4 _____

Failure to acknowledge receipt of each Addendum may be cause for rejection of the Bid.

NEW RIVER C & TC – ROOF RENOVATION

SIGNATURE: _____ DATE: _____
Signature in Ink

**LIST OF PROPOSED SUBCONTRACTORS
(To Be Completed and Submitted with Bid)**

List as designated below the proposed subcontractor for each major branch of work for this bid. Also, provide the subcontractor's license number as required by the West Virginia Contractors Licensing Act. If the branch of work is to be completed solely by the Bidder/Contractor, so indicate. If the acceptance of an alternate bid changes a subcontractor, indicate by notation below. The Bidder/Contractor may be requested to change an unsatisfactory subcontractor. The Bidder/Contractor is responsible for selecting or changing subcontractors. The Owner and Architect/Engineer may indicate their concerns about any entity listed which they have reason to believe past experience indicates that poor performance may be expected. The Bidder/Contractor has full responsibility for satisfactory execution of all work in accordance with the Contract Documents. Any change of proposed subcontractors shall be at no additional cost to the Owner, as the Bidder/Contractor has full responsibility for execution of the work. Bidder/Contractor shall have up to two hours after the bid opening to make adjustments if necessary. Owner will suffer loss should Contractor change from those listed beyond the two-hour time stipulated. Please email adjustments/modifications to Chief Procurement Officer at rich.donovan@wvhepc.edu.

Branch of Work/Material Category	Subcontractor/Supplier	Contractor License No.
1. _____	_____	_____
2. _____	_____	_____
3. _____	_____	_____
4. _____	_____	_____
5. _____	_____	_____
6. _____	_____	_____

**END OF FORM OF PROPOSAL
END OF SECTION 00300**

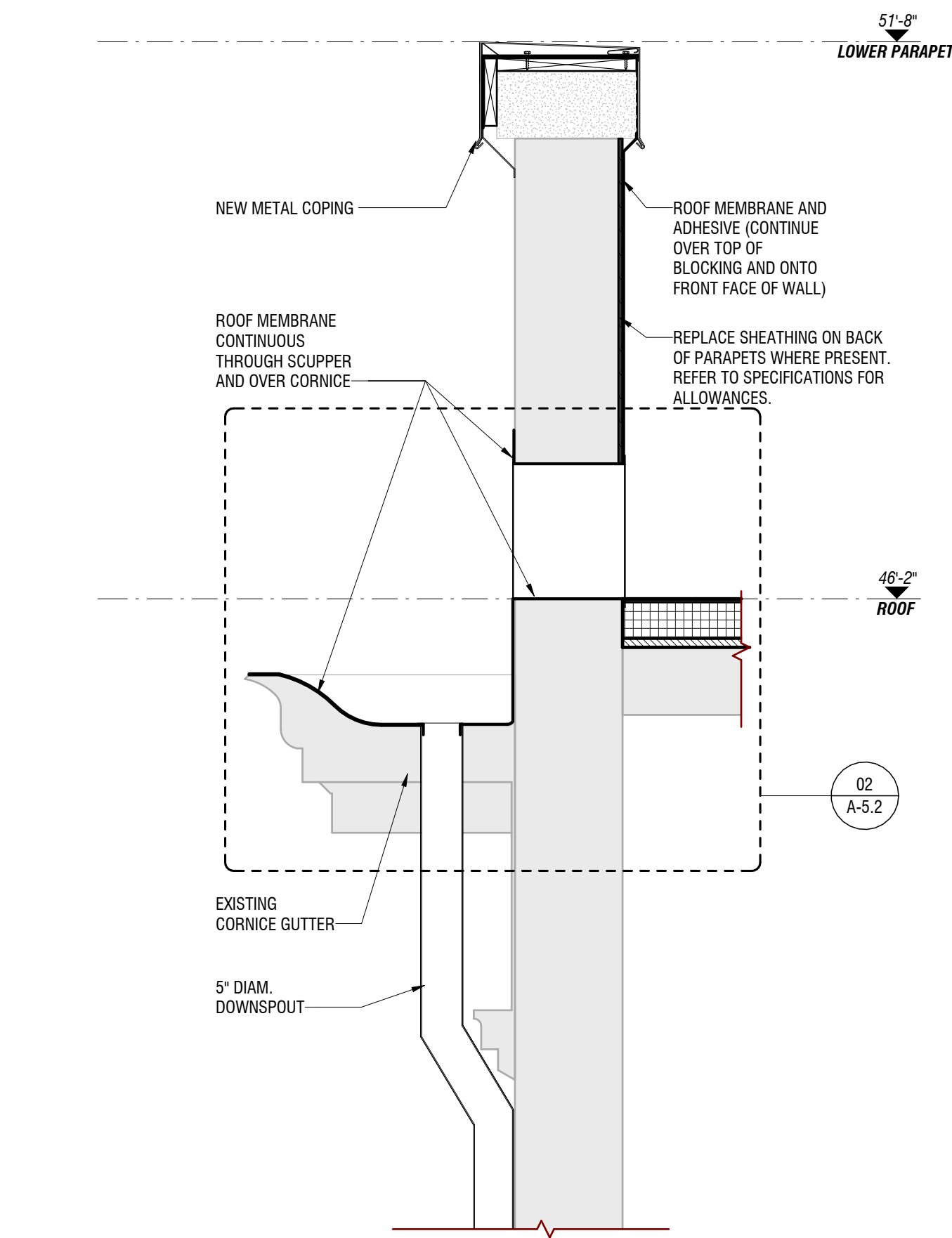

01 TYP. CORNICE GUTTER AND DOWNSPOUT
SCALE: 3/4" = 1'-0" SHEET: A-5.2

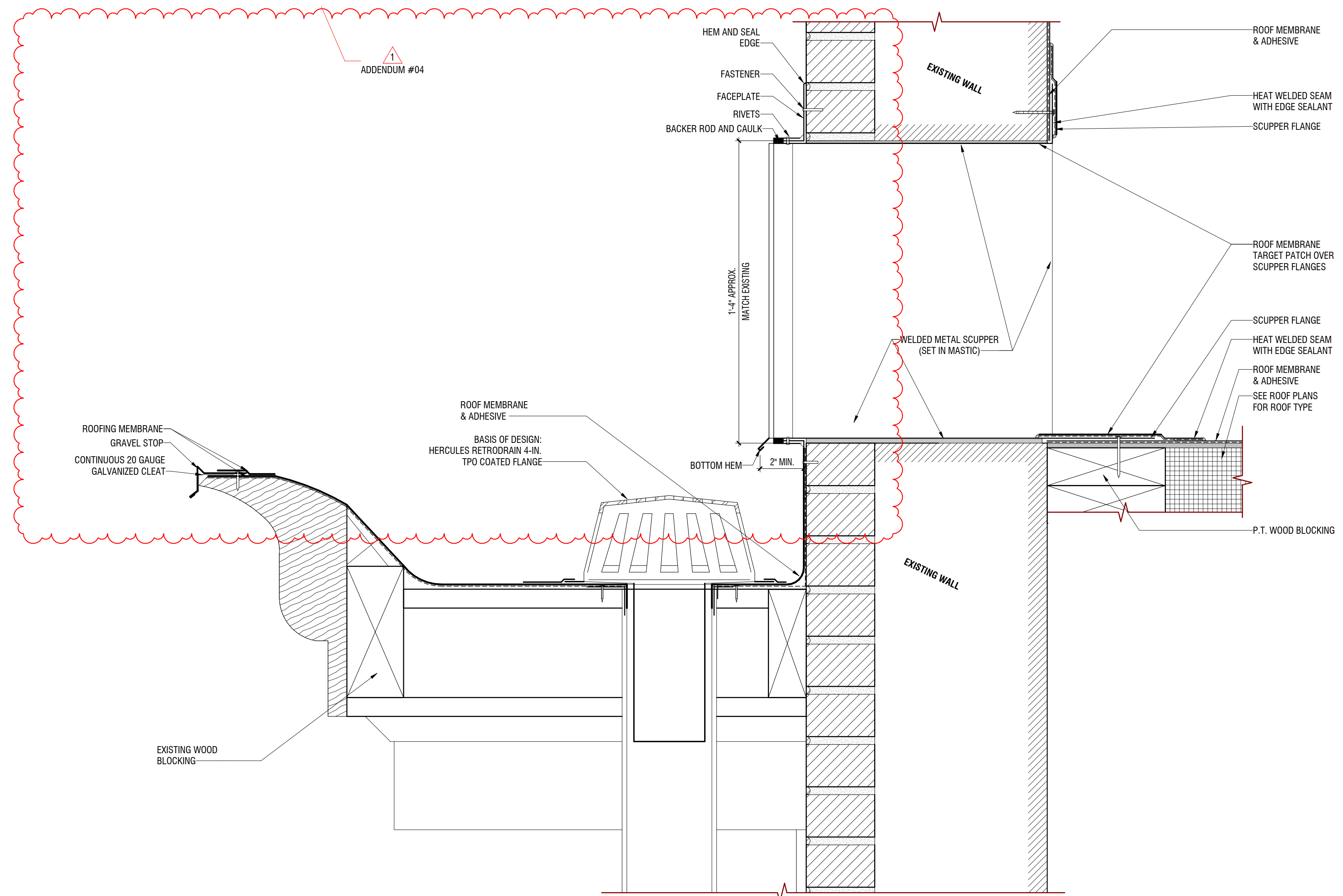

02 TYP. THRU-WALL SCUPPER AT CORNICE GUTTER
SCALE: 3" = 1'-0" SHEET: A-5.2

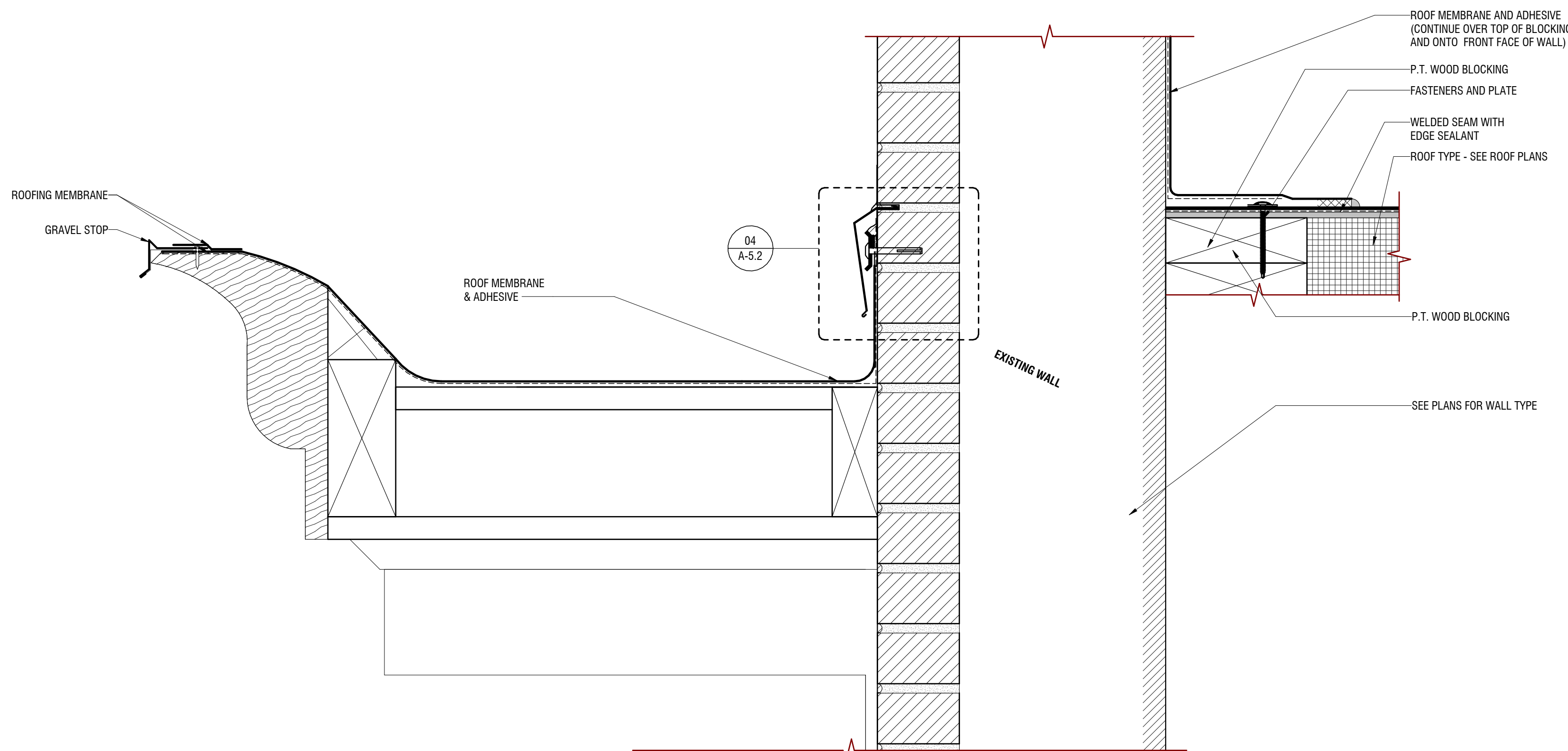

03 TYP. CORNICE GUTTER
SCALE: 3" = 1'-0" SHEET: A-5.2

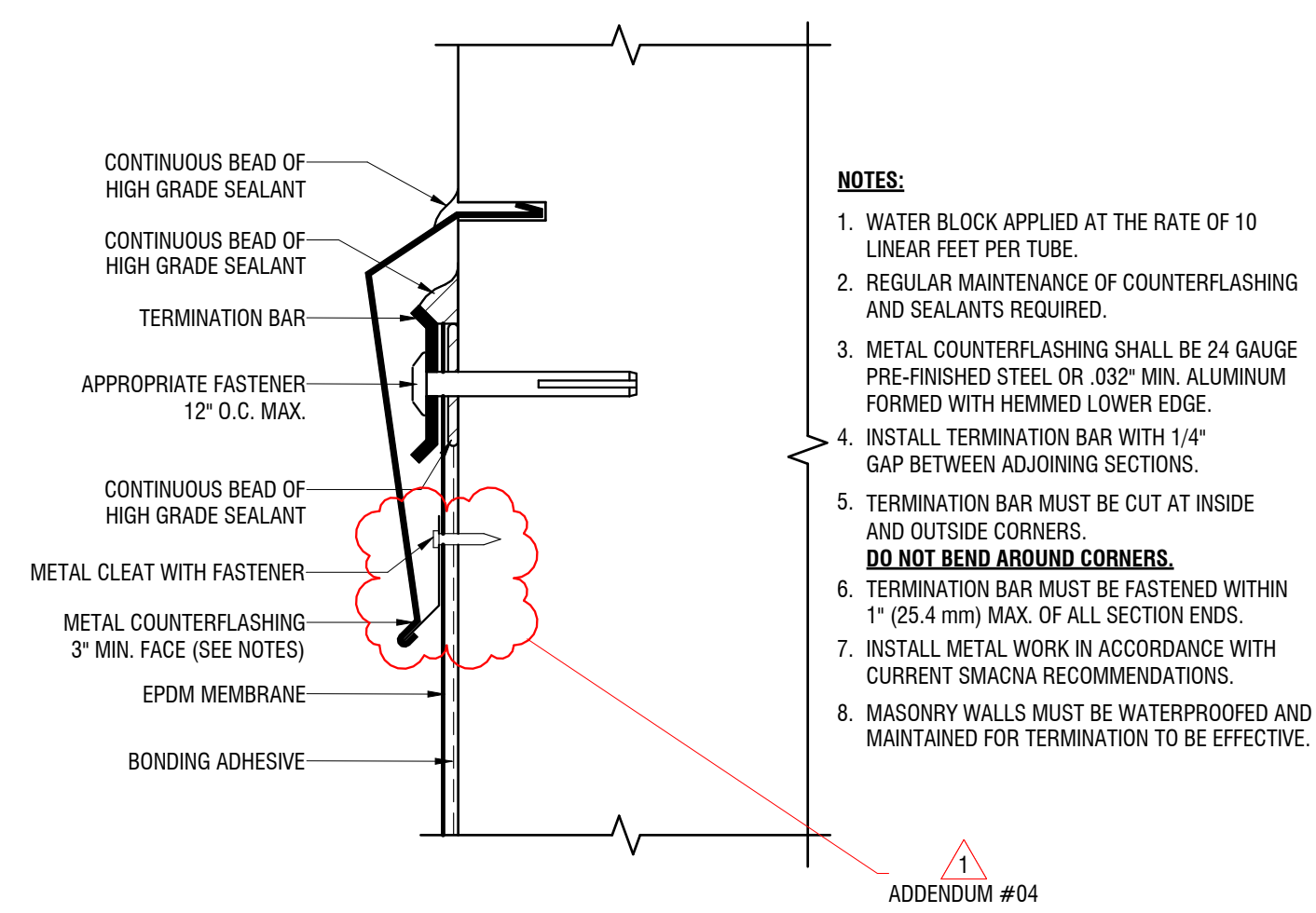

04 TERMINATION BAR AND REGLET
SCALE: 6" = 1'-0" SHEET: A-5.2

- NOTES:**
1. WATER BLOCK APPLIED AT THE RATE OF 10 LINEAR FEET PER TUBE.
 2. REGULAR MAINTENANCE OF COUNTERFLASHING AND SEALANTS REQUIRED.
 3. METAL COUNTERFLASHING SHALL BE 24 GAUGE PRE-FINISHED STEEL OR .032" MIN. ALUMINUM FORMED WITH HEMMED LOWER EDGE.
 4. INSTALL TERMINATION BAR WITH 1/4" GAP BETWEEN ADJOINING SECTIONS.
 5. TERMINATION BAR MUST BE CUT AT INSIDE AND OUTSIDE CORNERS. **DO NOT BEND AROUND CORNERS.**
 6. TERMINATION BAR MUST BE FASTENED WITHIN 1" (25.4 mm) MAX. OF ALL SECTION ENDS.
 7. INSTALL METAL WORK IN ACCORDANCE WITH CURRENT SMACNA RECOMMENDATIONS.
 8. MASONRY WALLS MUST BE WATERPROOFED AND MAINTAINED FOR TERMINATION TO BE EFFECTIVE.